

Workshop Announcement

International Workshop on Life-Cycle Costing of Offshore Wind Turbines and Farms

When: October 1, 2015 (the day after the AWEA Offshore WINDPOWER Conference in Baltimore)

Where: University of Maryland, College Park, Maryland, USA

Offshore wind farms are capital intensive projects whose economic viability depends on many things including: the wind resources, the technology, the depth of the water, the price of energy, and the successful long-term sustainment (or operation and maintenance, O&M) of the turbines. Accurate life-cycle costing is a key enabler for making offshore wind farm business cases and optimizing their management. This workshop will focus on forecasting life-cycle costs of turbines, wind farms, and their associated infrastructure.



Topics of interest include (but are not limited to):

- Cost of ownership
- Operations and maintenance analysis
- Maintenance infrastructure
- Condition-based health management
- Spare parts forecasting and inventory
- Economics of reliability
- Return on investment and business case analysis
- Financial modeling (e.g., WACC determination)
- Designing power purchase agreements (PPAs) and designing for PPAs
- Warranty analysis
- Life extension
- Inspection
- Energy availability
- No fault found
- Aging supply chain
- Real options analysis

If you are interested in attending or presenting please contact: Peter Sandborn, University of Maryland, sandborn@umd.edu, (301) 405-3167



International Workshop on Life-Cycle Costing of Offshore Wind Turbines and Farms

Agenda

Time	Title	Presenter	Organization
8:30	Introduction to the Workshop (The Sustainment of Wind Turbines and Wind Farms)	Peter Sandborn	University of Maryland
9:00	2014-2015 Offshore Wind Technologies Market Report: Progress towards Cost Reduction in Europe and Implications for the US Market	Aaron Smith	NREL
9:30	CoE Modeling for Offshore Turbines with Different Drive Train Types at Sites Varying Distances from Shore	James Carroll	University of Strathclyde (Glasgow, UK)
10:00	Break		
10:30	Offshore Wind Farm O&M Optimization Using Real Options Analysis	Xin Lei	University of Maryland
11:00	Wind Turbine Performance Analysis and Anomaly Detection based on Techniques Developed on SCADA Data	Peyman Mazidi	KTH (Sweden)
11:30	Reliability Predictions of Current OSW Turbine Designs	Aris Christou	University of Maryland
12:00	LCOE of Offshore Wind Farms - Identification & Reduction	Ashish Dewan	ECN (Netherlands)
12:30	Lunch		
1:00	Lunch		
1:30	Offshore Wind Balance of System Cost Modeling	Tyler Stehly	NREL
2:00	Power Purchase Agreement (PPA): Performance-Based Levelized Cost of Energy	Maira Bruck	University of Maryland
2:30	Maintenance and Operation Management Strategy to Reduce the Cost of Offshore Wind Power Generation	Joseph Arumala	University of Maryland Eastern Shore
3:00	Reducing Costs in the Offshore Wind Sector: From Modular Design to a Healthy Flow of Knowledge	Matei Rogin	University of Southern Denmark
3:30	Break		
4:00	Return on Investment (ROI) Modeling of Offshore Wind Farm O&M to Support Strategic Technology Insertion	Roozbeh Bakhshi	University of Maryland
4:30	Lessons Learnt from Whole Life Costing Applications	John Erkoyuncu	Cranfield University (UK)
5:00	Potential Life-Cycle Cost Reductions for Offshore Floating Wind Energy	Michael Borg	Technical University of Denmark
5:30	Wind Turbine Maintenance Optimization: The Impact of an Accurate Vertical Wind Profile Estimation	Navid Goudarzi	University of Maryland

General Information

Workshop Date and Location:

October 1, 2015, College Park Marriott Hotel & Conference Center adjacent to the University of Maryland in College Park Maryland.

The workshop will take place in: Chasen Family Room (see attached map for location of room)

Hotel Information:

College Park Marriott Hotel & Conference Center

3501 University BLVD

East Hyattsville, Maryland 20783 USA

Phone: +1-301-985-7300

Fax: +1-301-985-7517

<http://www.marriott.com/hotels/travel/wasum-college-park-marriott-hotel-and-conference-center/>

Information on transportation options and directions to College Park Marriott Hotel & Conference Center from the nearby airports is available here:

<http://www.marriott.com/hotels/maps/travel/wasum-college-park-marriott-hotel-and-conference-center/>

Directions from Dulles International Airport (IAD):

<http://www.marriott.com/hotels/maps/directions-results.mi?startLocation=&endLocation=&directionFromProperty=false&addressType=airport&marshaCode=wasum&country=&originDriveQuery=&originAddress=&originCity=&originState=&originCountry=&originZip=&language=en&originAirport=IAD&originAirportCode=IAD&mapLocation=mapEnd&language=en>

Directions from Reagan International Airport (DCA):

<http://www.marriott.com/hotels/maps/directions-results.mi?startLocation=&endLocation=&directionFromProperty=false&addressType=airport&marshaCode=wasum&country=&originDriveQuery=&originAddress=&originCity=&originState=&originCountry=&originZip=&language=en&originAirport=DCA&originAirportCode=DCA&mapLocation=mapEnd&language=en>



Directions from Baltimore/Washington International Airport (BWI):

<http://www.marriott.com/hotels/maps/directions-results.mi?startLocation=&endLocation=&directionFromProperty=false&addressType=airport&marshaCode=wasum&country=&originDriveQuery=&originAddress=&originCity=&originState=&originCountry=&originZip=&language=en&originAirport=BWI&originAirportCode=BWI&mapLocation=mapEnd&language=en>

Directions from AWEA at the Baltimore Convention Center:

<http://www.marriott.com/hotels/maps/directions-results.mi?startLocation=&endLocation=&directionFromProperty=false&addressType=street&marshaCode=wasum&country=&originDriveQuery=&originAddress=1+W+Pratt+St&originCity=%2C+Baltimore&originState=MD&originCountry=US&originZip=+21201&mapLocation=mapEnd&language=en&originAirport=&originAirportCode=&language=en>

Parking

Parking is complementary for all patrons of the hotel whether you are staying or just coming for the day. There is a garage adjacent to the building.

If you have any questions you can contact:

Ericka Black

Email: epair@umd.edu

Telephone: 301-405-3906

Registration

There is no registration fee, however, you need to submit the attached registration form by August 28, 2015 to Ericka Black (epair@umd.edu)

*** Invitation letters can be provided on request**



CONFERENCE BUILDING MAIN LEVEL

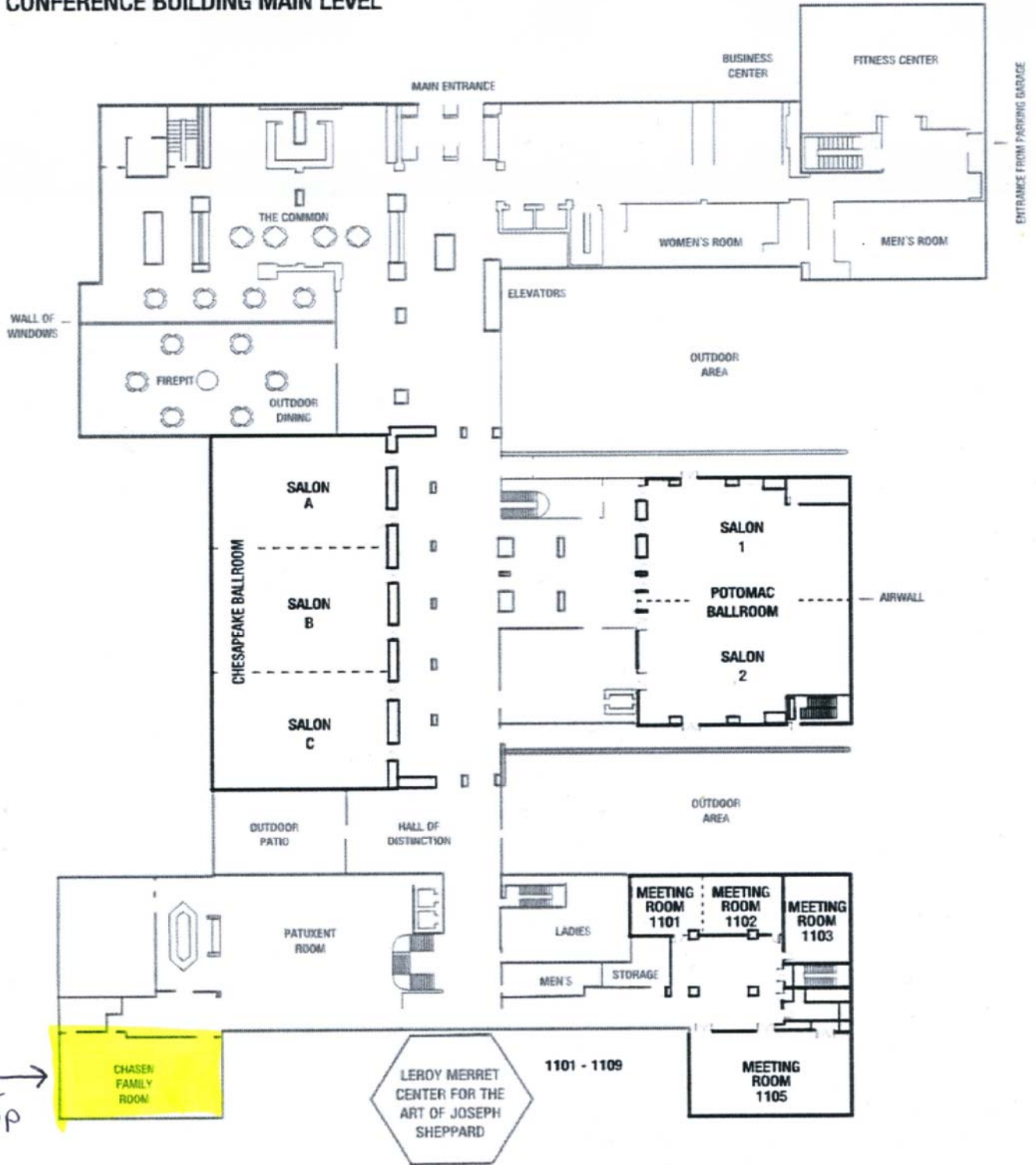

2015
Offshore
Workshop
Oct. 1st →

Registration Form

Return form by August 28, 2015 to Ericka Black (epair@umd.edu)

Name:

Title/Position:

Organization:

Organization Address:

Email:

Will you need parking?

Do you have any dietary restrictions?

Will you be attending dinner the night of October 1st?

Do you need a letter of invitation?

